

Antenna protection

These SPD's are designed to protect Radio- or TV-cables from disturbances from lightning and other surges.

The KO9P are specially designed to protect cable-TV.

KO-9P



KO-10P

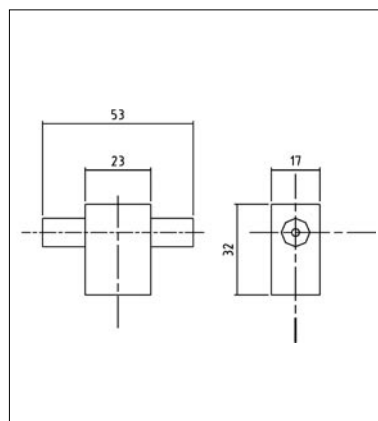
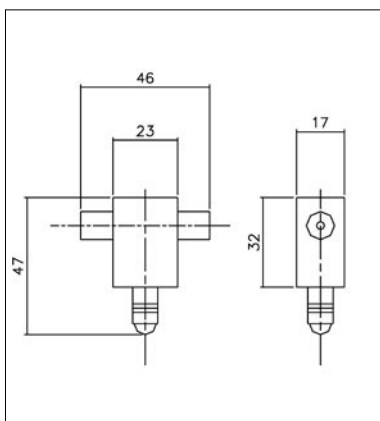

| Type | Frequency range | Attenuation (dB) | Impedance (Ω) | Interchange power | DC ignition voltage U_{zs} (at the steepness of <math><500\text{ V/s}</math> | E-number |
|------------------|-----------------|-----------------------------|------------------------|-------------------|--|-----------|
| KO-9P FF | 0-2 GHz | <math><0,5\text{ dB}</math> | 75 Ω | 50 W | 90 V | 52 708 80 |
| KO-10P MF | 0-1 GHz | <math><1,2\text{ dB}</math> | 75 Ω | 50 W | 90 V | 52 708 73 |